

3M

PELTOR™

**System Control Unit, SCU-300
Remote Control Unit, RCU-300**



3M™ PELTOR™ SCU-300, RCU-300

EN	1-12
ES	13-24
FR	25-36

3M™ PELTOR™ SCU-300 and RCU-300 SCU-300NA (all product variants)

1. INTRODUCTION

Congratulations and thank you for choosing 3M™ PELTOR™ communication solutions! Welcome to the next generation of protective communication.

1.1. INTENDED USE

This 3M™ PELTOR™ System Control Unit (SCU-300) connects and controls the individual components of the 3M™ PELTOR™ Tactical Modular Audio System. The SCU-300 also supports multiple, external communication device connections and serves as a single-source communications control device. The SCU-300 can be operated with the included Remote Control Unit (RCU-300). It is expected that users read and understand the provided user instructions to become familiar with the use and operation of these devices.

2. SAFETY

2.1. IMPORTANT

- Please read, understand, and follow all safety information in these instructions prior to use. Retain these instructions for future reference. For additional information or any questions, contact 3M Technical Services. Refer to contact information listed on the last page of this manual.



WARNING

Failure to follow these instructions may result in serious injury or death:

- To reduce the risks associated with igniting an explosion, do not use this product in a potentially explosive atmosphere.

2.2. CAUTION

- Always use product-specific 3M replacement parts. Use of unauthorized replacement parts may reduce the protection you receive from this product.
- Risk of explosion if battery is replaced by an incorrect type.
- With Lithium ion batteries, there is a risk of fire and burns. Do not open, crush, heat above [55°C (131°F)], or incinerate.

3. FCC AND IC INFORMATION

This device complies with Part 15 of the FCC rules and Industry Canada's license-exempt Radio Standards Specifications. Operation is subject to the following two conditions: (1) This device may not cause harmful interference, and (2) this device must accept any interference received, including interference that may cause undesirable operation.

Note: Changes or modifications not expressly approved by the manufacturer could void the user's authority to operate the equipment.

Note: This equipment has been tested and found to comply with the limits for a Class B digital device, pursuant to Part 15 of the FCC Rules. These limits are designed to provide reasonable protection against harmful interference in a residential installation. This equipment generates, uses and can radiate radio frequency energy and, if not installed and used in accordance with the instructions, may cause harmful interference to radio communications. However, there is no guarantee that interference will not occur in a particular installation.

If this equipment does cause harmful interference to radio or television reception, which can be determined by turning the equipment off and on, the user is encouraged to try to correct the interference by one or more of the following measures:

- Reorient or relocate the receiving antenna.
- Increase the separation between the equipment and receiver.
- Connect the equipment into an outlet on a circuit different from that to which the receiver is connected.
- Consult the dealer or an experienced radio/TV technician for help.

This portable device with its antenna complies with FCC/IC RF exposure limits for general population / uncontrolled exposure. The antenna used for this device must not be co-located or operating in conjunction with any other antenna or transmitter.

This Device complies with Industry Canada License-exempt RSS standard(s). Operation is subject to the following two conditions: (1) this device may not cause interference, and (2) this device must accept any interference, including interference that may cause undesired operation of the device.

4. OVERVIEW

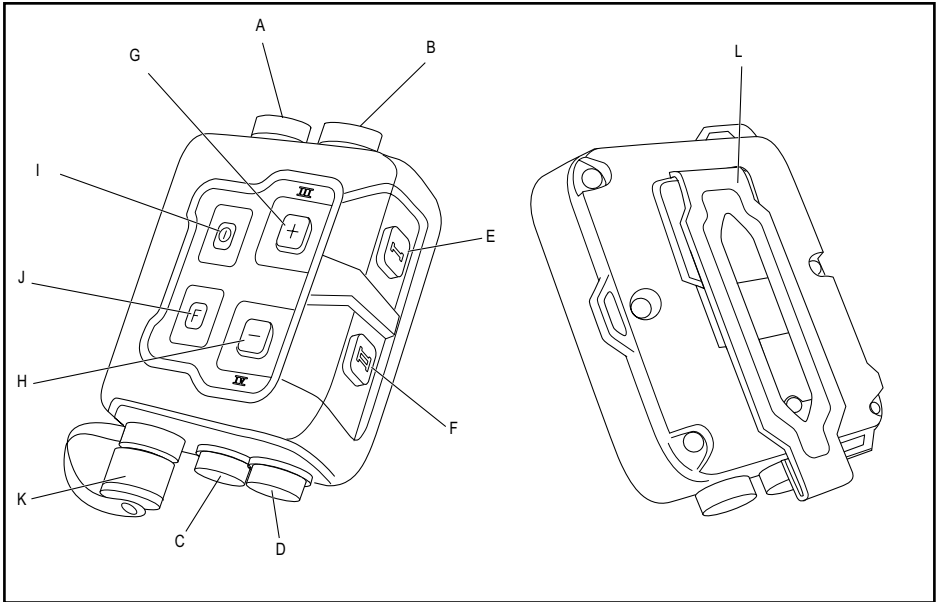

SCU-300

- A Intercom socket
- B Headset socket
- C Radio 1 socket
- D Radio 2 socket
- E PTT I button
- F PTT II button

- G + button
- H - button
- I On/Off/Menu button
- J Function button
- K Battery compartment cap
- L Metal clip

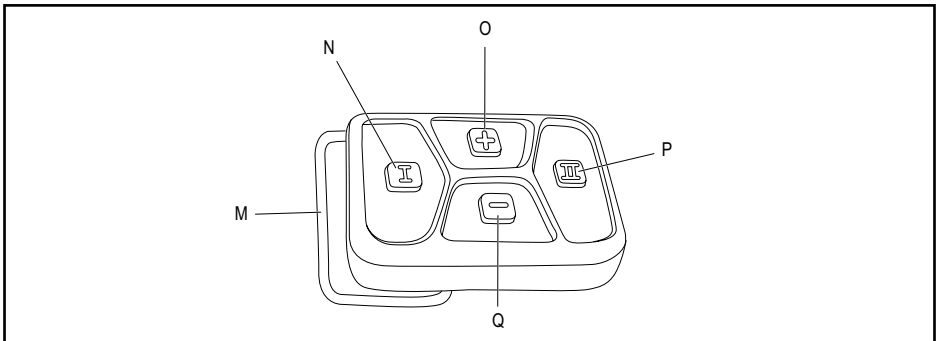

RCU-300

- M Locking bracket
- N PTT I button

- O + button
- P PTT II button
- Q - button

5. EXPLANATION OF SYMBOLS



Recycling Symbol. Recycle this product at a recycling station for electrical and electronic equipment.

NOTE: Other symbols/decals may occur on the product due to certification requirements for some commercial areas.

6. SETUP

6.1. TO INSERT THE BATTERIES IN THE SCU-300

The SCU-300 requires 2 AAA batteries to operate.

Note: The product is not supplied with batteries.

The TEP-300 and/or ComTac™ VII will indicate low battery level with an audio message "SCU Battery low".

1. Turn the battery cap counter clockwise to remove and access the battery compartment.

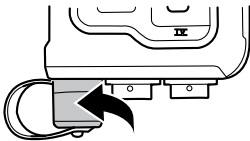

2. Insert 2 AAA batteries into the battery compartment according to the illustration.

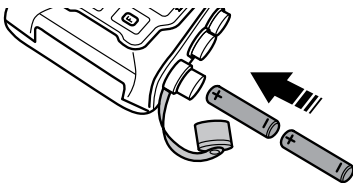

3. Replace the battery cap and turn clockwise to tighten.

6.2. TO POWER ON THE SCU-300

If the SCU-300 was previously connected to the TEP-300 or ComTac™ VII, the devices will connect automatically when within range of the SCU-300 and devices are powered on.

1. Power on the TEP-300 and/or ComTac™ VII. Refer to the user instructions for each device.

NOTE: The SCU must be positioned correctly during startup to correctly pair with each device. Refer to "6.7. To fit the scu-300".

2. Press and hold the On/Off/Menu button on the SCU-300 for ~3 seconds.

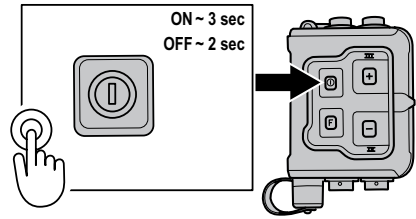

3. The TEP-300 and/or the ComTac™ VII will indicate pairing.

- 2 short beeps, indicates a successful pairing to the SCU-300.
- 3 long beeps, indicates the NFMI link is lost.



Note: Beeping sounds only occur if the headset has previously been paired with the SCU.

4. If pairing fails, check proper SCU placement. If problem persists, press the On/Off/Menu button on the SCU-300 for ~10 seconds or until 2 short beeps are heard in TEP-300 and/or the ComTac™ VII.

6.3. TO POWER ON THE SCU AND CONNECT THE TEP-300 AND/OR THE COMTAC™ VII FOR THE FIRST TIME

This product uses Near Field Magnetic Induction (NFMI), to connect wirelessly to the TEP-300 and/or ComTac™ VII. NFMI is a short range wireless physical layer that communicates by coupling a tight, low-power, non-propagating magnetic field between devices. The range is ≈ 50 cm/20 in. NFMI systems are designed to contain transmission energy within the localized magnetic field and the energy does not radiate into free space.

If not previously connected to the SCU-300, the TEP-300 and/or ComTac™ VII must be paired manually.

1. Power on the TEP-300 and/or the ComTac™ VII.
2. Press and hold the On/Off/Menu button on the SCU-300 for a minimum of ~10 seconds.

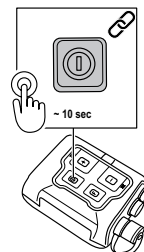

- 2 short beeping sounds indicate that the hearing protection is connected to the SCU-300.
- 3 long beeping sounds indicate that the NFMI link is lost. Press and hold the On/Off/Menu button for a minimum of 10 seconds to reconnect the hearing protection.



6.4. TO POWER ON THE RCU-300

1. Short press the + button to start the RCU.

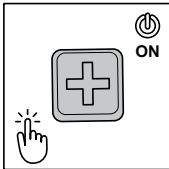

2. Press any button to wake up the RCU if it has gone into sleep mode.

6.5. TO POWER OFF THE PRODUCT

6.5.1. TO POWER OFF THE SCU-300

1. Press and hold the On/Off/Menu button on the SCU-300 for ~2 seconds.

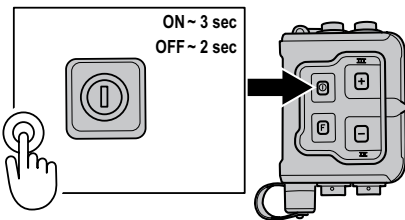

NOTE: If the connection between the SCU-300 and the TEP-300 and/or the ComTac™ VII is lost, the user will hear three long beeps.

6.5.2. TO POWER OFF THE RCU-300

1. Press and hold the + and - button at the same time for 2 seconds.

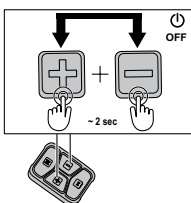

Note: The RCU-300 will go into sleep mode after 120 minutes after lost connection with SCU-300. There is no need to manually power off the RCU-300.

6.6. TO PAIR THE RCU-300 TO THE SCU-300

RCU-300 uses Bluetooth® Low Energy (BLE) communication. BLE is a short-range wireless communication protocol. It is designed for long battery life. The range is ≈ 50 cm/20 in.

Pairing the RCU-300 to the SCU-300 requires the use of the TEP-300 or ComTac™ VII headset. Refer to those product user instructions for use information.

1. Power on the SCU-300. Refer to "6.2. To power on the SCU-300".
2. Power on the RCU-300. Refer to "6.4. To power on the RCU-300".
3. Short press the power button on the SCU-300 to access the menu.

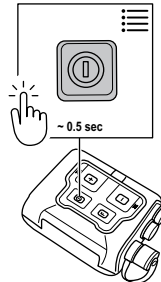

4. Short press the - button to move forward in the menu system until the audio message indicates the "Advanced Settings" sub menu.
5. Select "Advance Settings" by short pressing the + button.

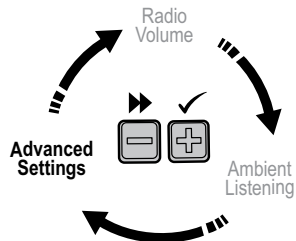

6. Short press the - button to move forward in the sub-menu system until the audio message indicates "Primary RCU pairing".
7. Select "Primary RCU pairing" with the + button.
8. Press and hold the PTT II button + and - button on the same time on the RCU-300.

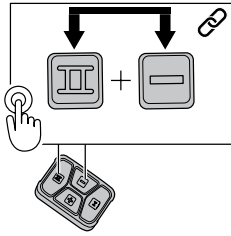

9. While pressing the buttons on the RCU-300, hold the RCU-300 against the SCU-300 to pair.

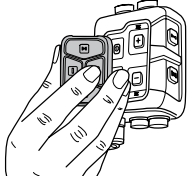

10. An audio message will indicate Primary/Secondary RCU connected.

Note: Select Secondary remote pairing and repeat the steps to pair a second RCU-300.

Note: To reset the RCU-300, press and hold the + and - button on the RCU-300 for 10 seconds.

6.7. TO FIT THE SCU-300

1. Slide the metal clip onto the rails on the back of the SCU-300.

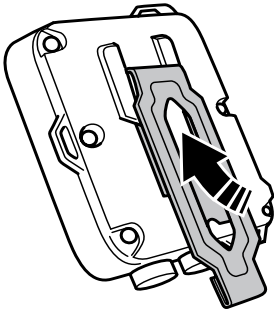

2. Attach the SCU-300 to your protective vest according to the illustration.

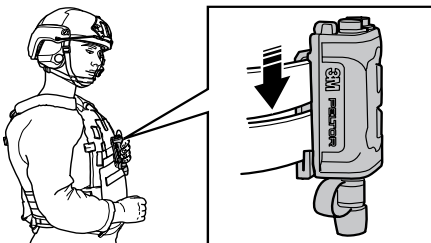

IMPORTANT! Make sure that the SCU-300 is placed in upright position and as high as possible within the chest area.

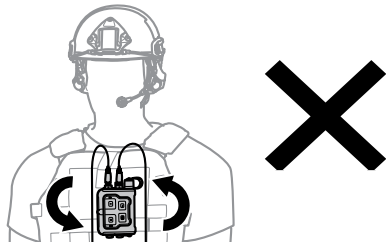
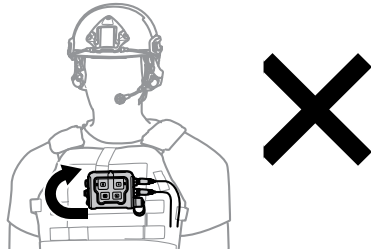
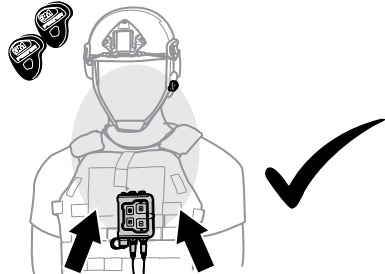
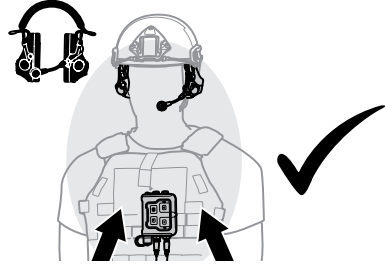

6.8. TO FIT THE RCU-300

1. Pull and lift the locking bracket of the RCU-300 outwards and upwards.

IMPORTANT! Make sure that the RCU-300 is placed within arm-length from the SCU-300.

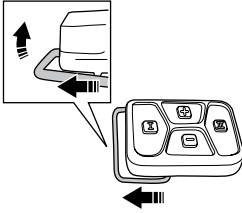

2. Slide the RCU-300 onto the rail system.

IMPORTANT! Make sure that the locking bracket is facing the barrel.

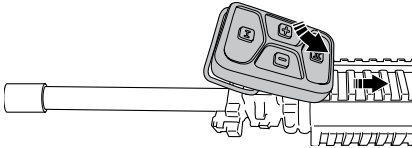

3. Fold down the locking bracket of the RCU-300.

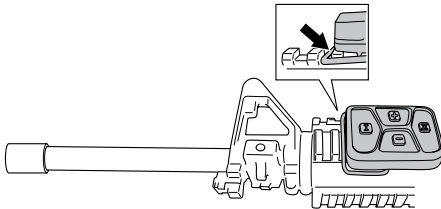

4. Pull the RCU-300 towards the barrel to lock it into place.

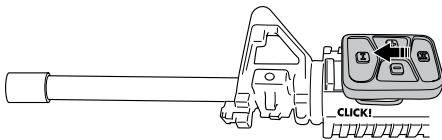

6.9. TO CONNECT TO AN EXTERNAL RADIO

1. Power on the radio.
2. Ensure radio volume is set to a comfortable level.
3. Connect the cable to the radio. For instructions how to connect the radio, refer to the radio manual.
4. Align the markings on the cable to the markings on the SCU-300.

IMPORTANT! Make sure to select the correct socket on the SCU-300 for the radio.

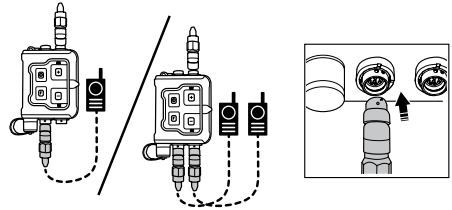

5. Connect the cable with the SCU-300 and turn the cable clockwise to lock into place.

6.10. TO CONNECT AN EXTERNAL INTERCOM

1. Connect the cable to the intercom system. For instructions how to connect the intercom system, refer to the intercom manual.
2. Align the markings on the cable to the markings on the SCU-300.

IMPORTANT! Make sure to select the correct socket on the SCU-300 for the intercom system.

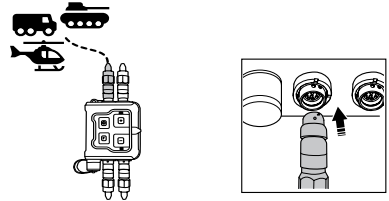

3. Connect the cable with the SCU-300 and turn the cable clockwise to lock into place.

6.11. TO CONNECT COMTAC™ VII WITH CABLE

The SCU-300 is designed to connect via cable to the ComTac™ VII headset when wireless connectivity is not desired.

1. Align the marking on the cable with the marking on the socket on the SCU-300.

IMPORTANT! Make sure to connect the ComTac™ VII to the socket with the headset marking on the SCU-300.

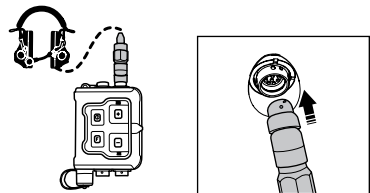

2. Connect the cable with the SCU-300 and turn the cable clockwise to lock into place.

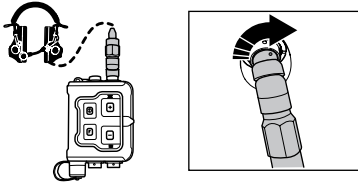

- Align the marking on the cable with the marking on the socket on the ComTac™ VII.
- Connect the cable with the ComTac™ VII and turn the cord clockwise to lock it into place.

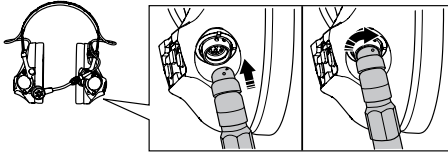

7. INSTRUCTIONS FOR OPERATION

7.1. OPERATING TEMPERATURE

- 20°C/-4°F to +55°C/131°F.
- Under extremely cold conditions, warm the device before using.

7.2. TO ADJUST THE AMBIENT (ENVIRONMENTAL) VOLUME

The environmental microphones allow the users to maintain auditory situational awareness and to communicate naturally in lower noise environments.

- The + button and - button on the SCU-300 and RCU-300 adjusts the Ambient (Environmental) Volume on the TEP-300 and/or ComTac™ VII.

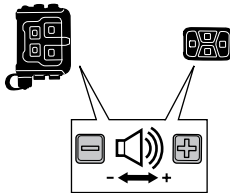

- Press the + button to increase the Ambient (Environmental) Volume.
- Press the - button to decrease the Ambient (Environmental) Volume. To mute the product, press the - button on the SCU-300/RCU-300 until an audio message indicates that the product is in silent mode "Ambient listening off".

Note: Volume control defaults to headset environmental/ ambient volume. To change the volume level on connected devices, refer to section "7.3. To Adjust the radio/intercom volume using the SCU-300 or RCU-300".

Note: When connected to an intercom system, this method of changing ambient (environmental) headset volume will not be available. In that case, it is necessary to enter the menu and select Ambient Listening Volume to change the volume of those devices.

7.3. TO ADJUST THE RADIO/INTERCOM VOLUME USING THE SCU-300 OR RCU-300

- Short press both + and - buttons simultaneously.

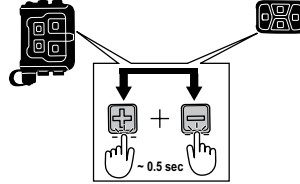

- Press either the + or - button to within 2 seconds to change the volume level on connected devices. After 2 seconds the volume control will return to set the environmental listening.

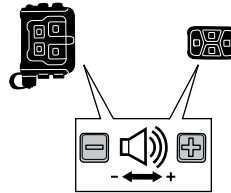

NOTE: When connected to an intercom system, this method of changing the volume of connected radios/intercom systems will not be available. In that case, it is necessary to enter the menu and select Radio Volume to change the volume of those devices.

7.4. TO ADJUST THE RADIO VOLUME ON THE RADIO

Refer to technical documentation for radio.

7.5. TO USE THE BLUETOOTH® FUNCTION**

7.5.1. MAKING OR ANSWERING PHONE CALLS WITH BLUETOOTH®**

When the SCU-300 is connected with Bluetooth® to a mobile device, you can use the Function button on the SCU-300 to answer, hang up or reject a call from your mobile device. You can also use the PTT II button on the RCU-300.

To be able to operate the Function button on the RCU-300, change the settings on the SCU-300. Refer to "7.5.2. To transfer the function button to the RCU-300".

Note: Before making or taking a call, make sure that the SCU-300 is connected to a mobile device.

To answer a call

- Press the Function button on the SCU-300 or PTT II button on the RCU-300 to answer a call from your mobile device. A short beep will be heard in the hearing protection before you hear the incoming call.

To hang up a call

- Press the Function button on the SCU-300 or PTT II button on the RCU-300 to hang up a call from your mobile device. A short beep will be heard in the hearing protection to indicate that the call has been ended.

To reject a call

- Press and hold the Function button on the SCU-300 or PTT II button on the RCU-300 to reject the call. A short beep will be heard in the hearing protection to indicate that the call has been rejected.

To make a call

- Dial the phone number from your connected mobile device. The call will automatically transfer to the headset.

To make a call using the voice guided function

- Press and hold the Function button on the SCU-300 or the PTT II button on the RCU-300 for 3 seconds to activate voice guided function. You will hear 2 quick beeps to indicate that the voice guided function is active and is waiting for your instructions.
- Say "call" followed by a name from your contact list or "dial" followed by a number.

7.5.2. TO TRANSFER THE FUNCTION BUTTON TO THE RCU-300

To add the Function button capability to the RCU-300, change the settings on the SCU-300.

- Short press the power button on the SCU-300 to access the menu.

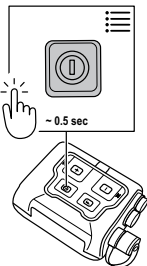

- Press the - button to move forward in the menu system until the audio message indicates the sub menu Advanced settings.

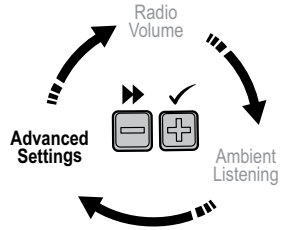

- Press the + button to confirm and to access Advanced settings.
- Press the - button to move forward in the menu system until the audio message indicates the sub menu Bluetooth® Function button to RCU.
- Press the + button to confirm.

Note: The PTT II button on the RCU-300 now has the same function as the Function button on the SCU-300.

7.6. TO NAVIGATE THE MENU SYSTEM - SCU-300

- Short press the On/Off/Menu button to enter the menu system.

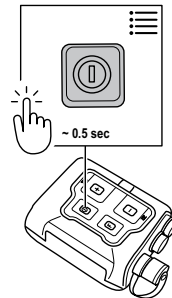

- Short press the - button to move forward in the menu system.
- Short press the + button to change the current menu setting.

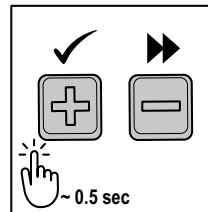

The menu will be heard as an audio message in the headset.

7.6.1. SCU-300 MENU

For more information about the menu, refer to "8. Menu functions SCU-300"

- Radio volume
- Ambient (Environmental) listening volume
- Primary Microphone*
- Advanced Settings
 - Battery Status
 - Radio Silence
 - Voice Guide Volume
 - NFMI pairing
 - Training Mode
 - SCU placement
 - Auto Power Off
 - Warning signals
 - RCU Primary pairing
 - RCU Primary pairing
 - Bluetooth® pairing**
 - Bluetooth® Function Button**
 - Primary microphone
 - Battery Type
 - Radio audio
 - System power OFF
 - Factory reset

8. MENU FUNCTIONS SCU-300

8.1. RADIO VOLUME

Adjusts the volume of connected external communication devices and intercom systems. Select one of the 5 preset volume levels.

8.2. AMBIENT (ENVIRONMENTAL) LISTENING VOLUME

Adjusts the Ambient (Environmental) volume on connected headsets. Select one of the preset volume levels.

8.3. PRIMARY MICROPHONE

Select the primary speech communications microphone.

Note: This menu level is only available when both TEP-300 and ComTac™ VII is connected to the SCU-300.

8.4. ADVANCED SETTINGS

8.4.1. BATTERY STATUS

Performs a battery status check on SCU-300, RCU, TEP-300 and/or ComTac™ VII.

8.4.2. RADIO SILENCE

Silences NIB, NFMI and Bluetooth signals emitted from the TMAS.

NOTE: Depending on the connected external communication device, this setting MAY NOT silence detectable signals emitting from those devices. Please refer to radio user manuals regarding radio silence.

8.4.3. VOICE GUIDE VOLUME

Set the volume on the automatic audio messages. Select between high or low based on the surrounding noise.

8.4.4. NFMI PAIRING

Pairs products to the SCU-300.

8.4.5. TRAINING MODE

Training mode is a test mode. The training mode allows the user to test which placement of the SCU-300 is the best for the current situation.

8.4.6. SCU PLACEMENT

Set where you want to place the SCU-300. Select between chest position (recommended) or waist position.

8.4.7. AUTO POWER OFF

The SCU-300 will automatically turn off after 2 hours if no buttons are pressed on the SCU-300 during this time.

Note: The product will not turn off automatically if TEP-300 or ComTac™ VII is connected and active.

Note: Press any button to delay auto power off.

8.4.8. WARNING SIGNALS

Enables or disables the different audio messages/warning signals heard in the headset.

- ON - Enables all warning signals.
- OFF - Disables all warning signals.

8.4.9. RCU PRIMARY PAIRING

Pair the primary RCU with the SCU-300.

8.4.10. RCU SECONDARY PAIRING

Pair the secondary RCU with the SCU-300.

Note: This menu level is only available when a primary RCU-300 is already connected to the SCU-300.

8.4.11. BLUETOOTH® PAIRING**

Pair the selected Bluetooth® unit with the SCU-300.

8.4.12. BLUETOOTH® FUNCTION BUTTON**

Transfer the functions of the Function button on the SCU-300 to the PTT II button on the RCU-300. Refer to "11.5 To use the Bluetooth® function".

8.4.13. PRIMARY MICROPHONE

Select the primary speech communications microphone for TEP-300 or ComTac™ VII if not paired.

8.4.14. BATTERY TYPE

Set the type of battery used on the SCU-300. Battery type is used for battery life estimations.

- Alkaline - Sets the battery mode to alkaline battery.
- Rechargeable - Sets the battery mode to rechargeable battery.

8.4.15. RADIO AUDIO

Select 1 of the 3 preset sound profiles when you are using 2 radio and/or 2 channels. The sound profiles sets how the sound from the radio and/or channel 1 and 2 will be heard.

Note: All other channels will be heard in both ears.

- Mix - The sound will be heard equally in both left and right ear.
- Surround - The sound will be perceived as it is coming from different directions. For example, 10 o'clock and 14 o'clock.
- Single - The sound will only be heard in one of the ears.

8.4.16. SYSTEM POWER OFF

Turns off all products connected to the Tactical Modular Audio System.

8.4.17. FACTORY RESET

Reset the SCU-300 to the original settings.

9. TROUBLESHOOTING

Problem	Solution
The SCU-300 will not power on.	Make sure the batteries are inserted correctly.
	Make sure there are fully charged batteries in the SCU-300.
The SCU-300 will not send and/or receive radio communications.	Check the cable connection to the radio and the SCU. A voice message will indicate "Radio connected".
	Ensure the SCU-300 is powered on.
	Check the radio volume.
	Make sure the radio is on.
The SCU-300 will not send and/or receive intercom communications.	Make sure that you are transmitting on the correct frequency.
	Make sure there are fully charged batteries in the SCU-300.
	Check the volume.
	Make sure the intercom is on.
	Make sure the intercom is connected. A voice message will indicate "Intercom connected".
	Ensure the SCU-300 is in HOT MIC mode or that you are pressing the specified SCU PTT button and the intercom PTT button if needed.

The SCU-300 will not connect with or operate the ComTac™ VII and/or TEP-300.	Make sure there are fully charged batteries in the SCU-300.
	Restart the ComTac™ VII and/or TEP-300. For more information see product manuals for ComTac™ VII and/or TEP-300.
	Restart the SCU-300.
	Make sure the SCU-300 is correctly fitted and aligned with ComTac™ VII. Refer to the manual for "3M™ PELTOR™ Tactical Modular Audio System".
	Make sure the products in the 3M™ PELTOR™ Tactical Modular Audio System have been started in the correct order. Refer to the manual for "3M™ PELTOR™ Tactical Modular Audio System".
	Press and hold the menu button on the SCU-300 for at least 10 seconds or until 2 short beeps indicates a successful pairing. The headset will indicate "NFMI pairing on".
	Do a factory reset of the SCU-300. Refer to "8.4.19. Factory reset".
NFMI connection is unstable.	If several users are placed close to each other, connect your headset to SCU-300 with the headset cable. Refer to "6.9. To connect to an external radio".
I get thrown out of the menu.	The user automatically exits the menu if no button is pressed for 10 seconds.
I cannot control the system with the RCU-300.	Make sure there are fully charged batteries in the SCU-300.
	Check the battery level of the RCU-300. Refer to "8.4.1. Battery status".
	Pair the SCU-300 to the RCU-300. Refer to "6.6. To pair the RCU-300 to the SCU-300".
	Make sure that you are using the correct RCU-300.
	Do a factory reset of the RCU-300. Refer to "6.4. To power on the RCU-300".

10. STORAGE AND DISPOSAL

10.1. STORAGE

- Clean the product before storage.
- Examine the product for wear or damage.
- Keep the product in a clean and dry area within a temperature range of: -20°C/-4°F to 50°C/122°F.
- Do not put the product in sunlight during storage.
- During long term storage, remove the batteries from the battery holder.

10.2. DISPOSAL

- Obey national regulations.
- To properly dispose of the battery, follow local solid waste disposal regulations.
- Use the local recycling system for electronic equipment.
- This product contains electrical and electronic components and must not be disposed of using standard refuse collection. Please consult local directives for disposal of electrical and electronic equipment.

10.2.1. BATTERY DISPOSAL

Many rechargeable batteries are required to be recycled by local, state/province, and national laws. To properly recycle/dispose of the battery or battery pack, always follow local solid waste disposal regulations.

11. MAINTENANCE

11.1. TO CLEAN THE PRODUCT

- Wipe the product with a lightly damp cloth. Keep the battery cap and sockets free from dirt and other debris.
- Keep the battery cap and sockets free from dirt and other materials.

12. ACCESSORIES

Name	Type
RCU-300NA/1	3M™ PELTOR™ Remote Control Unit, RCU-300NA
FE0344/1	3M™ PELTOR™ Spring steel bracket RCU-300
DE0408/1	3M™ PELTOR™ Battery cap kit
TKD8003/1	3M™ PELTOR™ SCU Attachment clip

For more information about spare parts and accessories, please contact 3M Technical Services. Refer to contact information listed on the last page of this manual.

13. WARRANTY AND LIMITATION OF LIABILITY

NOTE: The following statements do not apply in Australia and New Zealand. Consumers should rely on their statutory rights.

13.1. WARRANTY

In the event any 3M Personal Safety Division product is found to be defective in material, workmanship, or not in conformity with any express warranty for a specific purpose, 3M's only obligation and your exclusive remedy shall be at 3M's option, to repair, replace or refund the purchase price of such parts or products upon timely notification of the issue by you and substantiation that the product has been stored, maintained and used in accordance with 3M's written instructions.

EXCEPT WHERE PROHIBITED BY LAW, THIS WARRANTY IS EXCLUSIVE AND IS IN LIEU OF ANY EXPRESS OR IMPLIED WARRANTY OF MERCHANTABILITY, FITNESS OR A PARTICULAR PURPOSE OR OTHER WARRANTY OF QUALITY, OR THOSE ARISING FROM A COURSE OF DEALING, CUSTOM OR USAGE OF TRADE, EXCEPT OF TITLE AND AGAINST PATENT INFRINGEMENT.

3M has no obligation under this warranty with respect to any product that has failed due to inadequate or improper storage, handling, or maintenance; failure to follow product instructions; or alteration or damage to the product caused by accident, neglect, or misuse.

13.2. LIMITATION OF LIABILITY

EXCEPT WHERE PROHIBITED BY LAW, IN NO EVENT SHALL 3M BE LIABLE FOR ANY DIRECT, INDIRECT, SPECIAL, INCIDENTAL OR CONSEQUENTIAL LOSS OR DAMAGES (INCLUDING LOST PROFITS) ARISING FROM THIS PRODUCT, REGARDLESS OF THE LEGAL THEORY ASSERTED. THE REMEDIES SET FORTH HEREIN ARE EXCLUSIVE.

13.3. NO MODIFICATION

Modifications to this device shall not be made without the written consent of 3M Company. Unauthorized modifications may void the warranty and the user's authority to operate the device.

NOTE:

- Do not mix old and new batteries.
- Do not mix alkaline, standard, or rechargeable batteries.
- To properly dispose of the battery, follow local solid waste disposal regulations.
- Only use AA non-rechargeable or Ni-MH rechargeable (as applicable) batteries.

3M™ PELTOR™ SCU-300 y RCU-300 SCU-300NA (todas las variantes de producto)

1. INTRODUCCIÓN

¡Felicidades y gracias por elegir soluciones de comunicación 3M™ PELTOR™! ¡Bienvenido a la siguiente generación de comunicación protectora!

1.1. USO PREVISTO

La unidad 3M™ PELTOR™ System Control Unit (SCU-300) conecta y controla los componentes individuales del sistema 3M™ PELTOR™ Tactical Modular Audio System. SCU-300 acepta también conexiones de dispositivo de comunicación múltiples externos y se usa como dispositivo de control de comunicaciones de una fuente. SCU-300 se puede manejar con la unidad Remote Control Unit (RCU-300) incluida. Los usuarios deben leer y comprender las instrucciones de empleo proporcionadas y estar familiarizados con el uso de estos dispositivos.

2. SEGURIDAD

2.1. ¡IMPORTANTE!

- Antes de usar el dispositivo, el usuario debe leer, comprender y observar toda la información de seguridad de estas instrucciones. Conservar estas instrucciones para futuras referencias. Para más información y consultas, contactar al servicio técnico de 3M. Ver los datos de contacto en la última página de este manual.



¡ADVERTENCIA!

El no seguir estas instrucciones podría resultar en daños personales o incluso la muerte:

- Para reducir los riesgos de incendio y explosión, no usar este producto en atmósferas potencialmente explosivas.

2.2. ¡PRECAUCIÓN!

- Usar siempre repuestos 3M específicos del producto. El uso de repuestos no autorizados puede reducir la protección que proporciona este producto.
- Riesgo de explosión si las baterías se sustituyen por unidades de tipo incorrecto.
- Con baterías de ion de litio hay riesgo de incendio y quemaduras. No abrir, aplastar ni calentar a más de 55 °C/131 °F, ni incinerar.

3. INFORMACIÓN SOBRE FCC E IC

Los cambios o modificaciones al equipo no aprobados expresamente por la parte responsable del cumplimiento podrían anular la autoridad del usuario para operar el equipo. Este dispositivo cumple con la Parte 15 de las Reglas de la FCC. La operación está sujeta a las siguientes dos condiciones: (1) este dispositivo no puede causar interferencia perjudicial, y (2) este dispositivo debe aceptar cualquier interferencia recibida, incluida la interferencia que puede causar una operación no deseada

Nota: Cualquier cambio o modificación que no esté expresamente aprobado por el fabricante podría anular la autoridad del usuario para operar el equipo.

Nota: Este equipo ha sido probado y cumple con los límites para un dispositivo digital de Clase B, de conformidad con la Parte 15 de las Reglas de la FCC. Estos límites están diseñados para proporcionar una protección razonable contra interferencias perjudiciales en una instalación residencial. Este equipo genera, utiliza y puede irradiar energía de

radiofrecuencia y, si no se instala y utiliza de acuerdo con las instrucciones, puede causar interferencias perjudiciales en las comunicaciones de radio. Sin embargo, no hay garantía de que no se produzcan interferencias en una instalación en particular.

Si este equipo causa interferencias perjudiciales en la recepción de radio o televisión, lo cual puede determinarse apagando y encendiendo el equipo, se recomienda al usuario que intente corregir la interferencia mediante una o más de las siguientes medidas:

- Reoriente o reubique la antena receptora.
- Aumente la separación entre el equipo y el receptor.
- Conecte el equipo a una toma de corriente en un circuito diferente al que está conectado el receptor.
- Consulte al distribuidor o a un técnico experimentado de radio / TV para obtener ayuda.

Este dispositivo portátil con su antena cumple con los límites de exposición a RF de la FCC / IC para la población general / exposición no controlada. La antena utilizada para este dispositivo no debe ubicarse ni utilizarse junto con ninguna otra antena o transmisor.

4. SINOPSIS

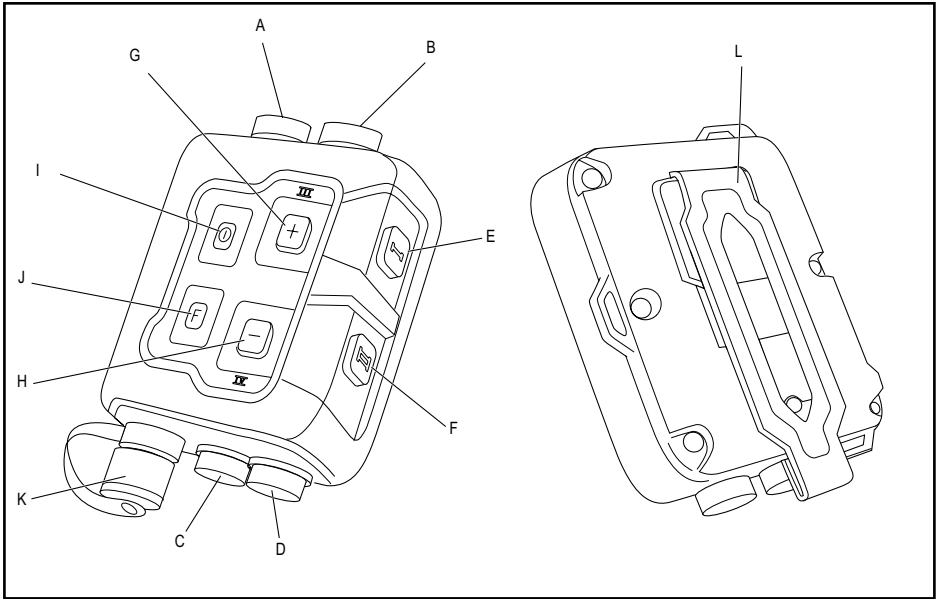

SCU-300

- A Conector de intercomunicador
- B Conector de orejera
- C Conector de radio 1
- D Conector de radio 2
- E Botón de pulsar para hablar PTT I
- F Botón de pulsar para hablar PTT II

- G Botón +
- H Botón -
- I Botón On/Off/Menu (encender/apagar/menú)
- J Botón de función
- K Tapa de compartimento de baterías
- L Broche metálico

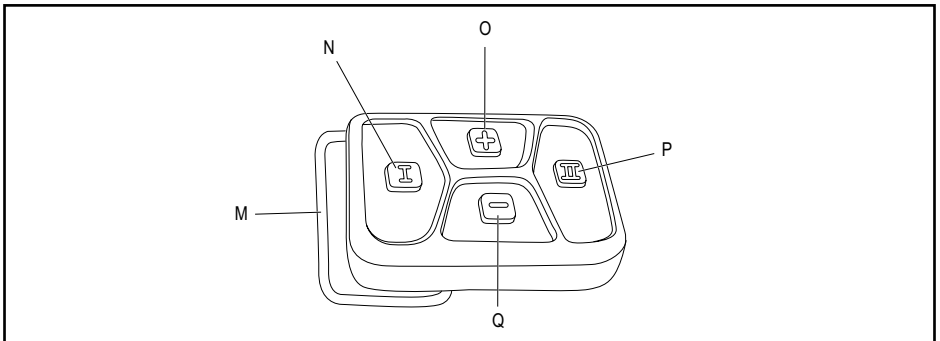

RCU-300

- M Pieza de retención
- N Botón de pulsar para hablar PTT I

- O Botón +
- P Botón de pulsar para hablar PTT II
- Q Botón -

5. EXPLICACIÓN DE SÍMBOLOS



Símbolo de reciclado. Reciclar este producto en un centro de reciclado de equipos eléctricos y electrónicos.

NOTA: En el producto puede haber otros símbolos y calcomanías, debido a requisitos de certificación para algunas áreas comerciales.

6. PREPARACIÓN

6.1. COLOCACIÓN DE LAS BATERÍAS EN LA SCU-300

La unidad SCU-300 funciona con 2 baterías tipo AAA.

Nota: Las baterías no se incluyen en la entrega del producto.

Los equipos TEP-300 y ComTac™ VII indicarán carga baja de las baterías con el mensaje de voz: "SCU Battery low" (carga baja de las baterías).

1. Quitar la tapa del compartimento de las baterías girándola hacia la izquierda para acceder al compartimento.

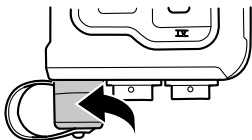

2. Colocar 2 baterías tipo AAA en el compartimento de baterías, como se muestra en la figura.

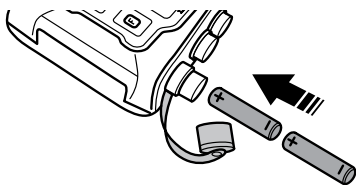

3. Poner la tapa del compartimento de baterías y apretarla girando a hacia la derecha.

6.2. ENCENDIDO DE LA SCU-300

Si la unidad SCU-300 ha estado anteriormente conectada a los equipos TEP-300 o ComTac™ VII, los dispositivos se conectarán automáticamente al encenderlos dentro del alcance de SCU-300.

1. Encender el TEP-300 y/o ComTac™ VII. Ver el manual de instrucciones de cada dispositivo.

NOTA: La unidad SCU debe estar correctamente posicionada durante la activación para que se haga el emparejamiento correcto con cada dispositivo. Ver "6.7. Para montar SCU-300".

2. Mantener presionado el botón On/Off/Menu del SCU-300 durante ~3 segundos.

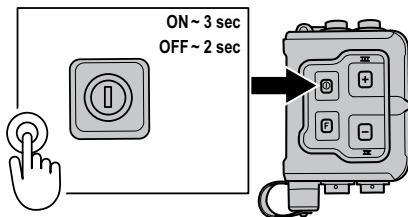

3. El dispositivo TEP-300 o ComTac™ VII indicará el emparejamiento.

- 2 pitidos cortos indican el emparejamiento correcto de la SCU-300.
- 3 pitidos largos indican que se ha perdido la conexión de NFMI.



Nota: Los pitidos solo se producen si los audífonos han estado anteriormente emparejada con la SCU.

4. Si falla el emparejamiento, comprobar que la SCU está colocada correctamente. Si el problema persiste, presionar el botón On/Off/Menu de la SCU-300 durante ~10 segundos o hasta que suenen 2 pitidos cortos en el TEP-300 o ComTac™ VII.

6.3. ENCENDIDO DE LA SCU Y CONEXIÓN CON EL TEP-300 o COMTAC™ VII POR PRIMERA VEZ

Este producto usa inducción magnética de campo cercano (NFMI) para la conexión inalámbrica con el TEP-300 o ComTac™ VII. NFMI es una capa física inalámbrica de corto alcance que comunica acoplando un campo magnético de baja potencia, ajustado, no propagante. El alcance es ≈ 50 cm/20 in. Los sistemas NFMI están diseñados para contener energía transmisora dentro del campo magnético localizado, sin que la energía se irradie en el espacio libre.

Si no ha estado anteriormente conectado a la SCU-300, TEP-300 o ComTac™ VII debe emparejarse manualmente.

1. Encender el TEP-300 y/o ComTac™ VII.
2. Mantener presionado el botón On/Off/Menu de la SCU-300 durante ~10 segundos.